

Pomeas TC Standard Telecentric Lens Series

PMS-08ST90

- 1.Support 1MP camera or below.
- 2.Low distortion,high telecentricity and deep depth of field, more suitable for high precision positioning and measuring.
- 3.Telecentric design.
- 4.Support 1/2" sensor.
- 5.Standard C-mount.



MAX.Sensor Size
1/2"

Magnification
0.8X

Working Distance
90.5mm

Resolution
8.947μm

C-Mount

Code		PMS-08ST90
Magnification		0.8X
Field of View	1/4"	4.0mm×3.2mm
	1/3"	6.0mm×4.5mm
	1/2.5"	7.2mm×5.4mm
	1/2.3"	7.7mm×5.8mm
	1/2"	8.0mm×6.0mm
	1/1.8"	--
	2/3"	--
Working Distance		90.5mm
Resolution		8.947μm
F.NO.		10.67
TV Distortion		0.02%
Depth of Field		1.33mm
N.A.		0.0375
MAX.Sensor Size		1/2"
Mount		C-Mount
Illumination		--
Working Temperature		-10°C~+50°C

C-Mount

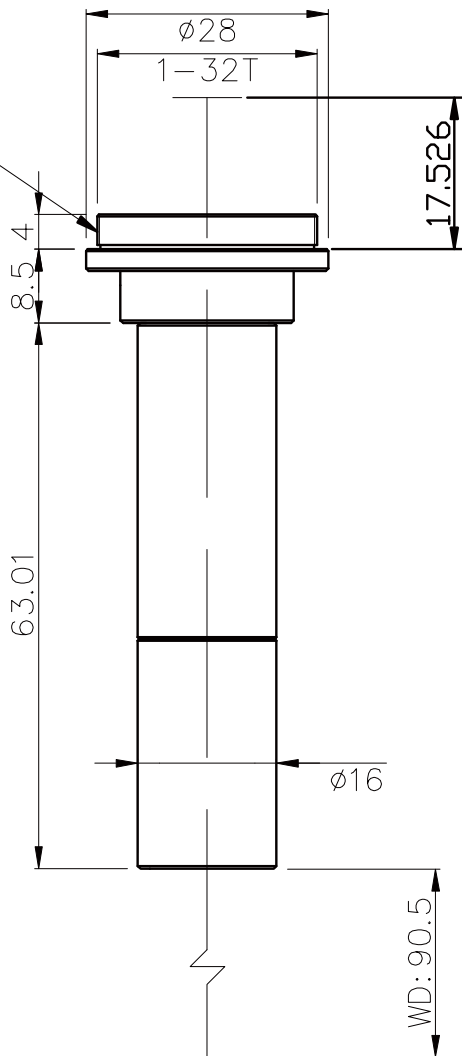

Unit:mm	Scale	1:1
	Name	PMS-08ST90
0.0 1.0 mm 25.0	Date	2012.6.20
POMEAS		